

Fastening Elements
紧固件

Anti-torsion Subsequent Nut
防扭后置螺母

Prevent torsion from connecting profiles with screw connectors.
防扭后置螺母用于防止型材之间用螺栓连接时的扭转。

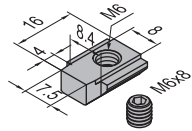
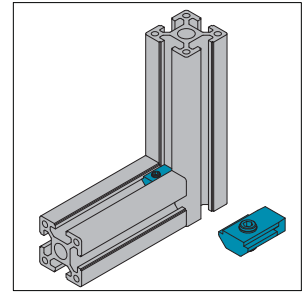

Description 产品描述	Material 材质	Mass 重量 (g/pcs)	Part No. 订购编号
Anti-torsional Subsequent Nut-8 (with top thread) 8槽防扭后置螺母 (含顶丝)	nickel plated steel 碳钢镀镍	10	2.32.08.M6

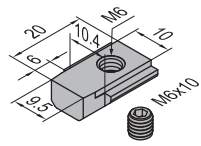

Description 产品描述	Material 材质	Mass 重量 (g/pcs)	Part No. 订购编号
Anti-torsional Subsequent Nut-10 (with top thread) 10槽防扭后置螺母 (含顶丝)	nickel plated steel 碳钢镀镍	15	2.32.10.M6